

Power LEDs Line series

Power LEDs Line IP65

Power LEDs Line IP65 1325 (One End Lead Wire)



Luci Pte., Ltd.

2019.08.23

■ Front View

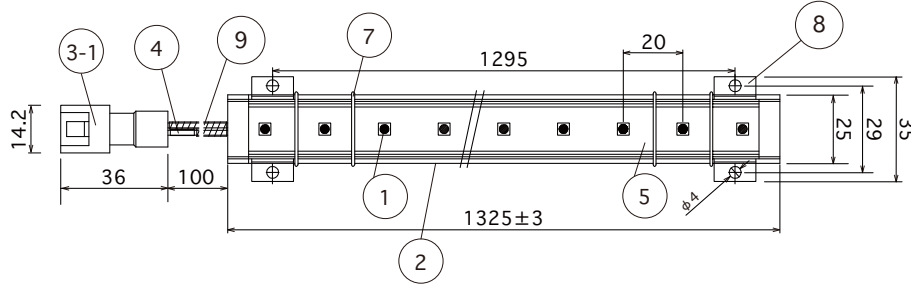

■ Side View

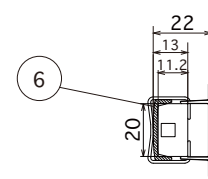

Option parts :End clip
(ELA1-P-FE)

Top view

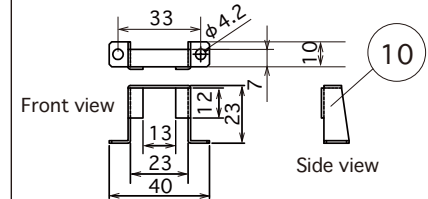

Front view

Side view

Option parts :Joint cable 500・1000・2000・4000・6000
(EECC220-805・EECC220-810・EECC220-820・EECC220-840・EECC220-860)

Top view

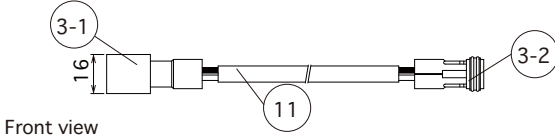

Front view

Side view

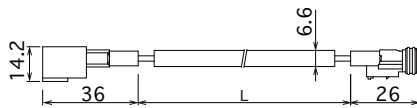

Option parts :Power supply cable 500・1000・2000・4000
(EPYC220-805・EPYC220-810・EPYC220-820・EPYC220-840)

Top view

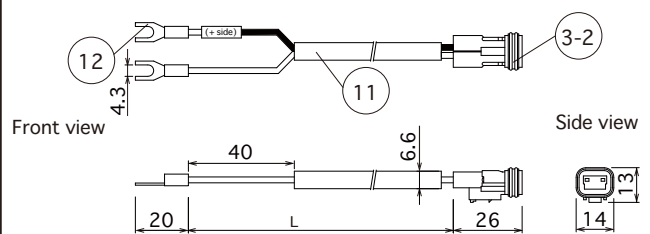

Front view

Side view

⚠ Check the label on the DC + side for polarity.

The specifications are subject to change without prior notice. Unit Of Measure : mm

	Part Name	Material	Note	Drawing
1	LED		SMD type	
2	Body	Aluminum	Silver	
3	Connector	PBT	CL07D-02M, CL07D-02A	
4	Lead wire	Heat resistant fluorine electric wire	0.5sq	
5	Lens	Acrylic	Clear (Medium / Narrow)	
6	Protective cover	Polycarbonate	Clear	
7	Fixing spring	Stainless	Silver	
8	Mounting clip	Aluminum	Silver	
9	Spiral tube	Nylon	Black	
10	End clip	Stainless	Silver	
11	Cable		VCTF 0.3sq	
12	Crimped terminal		Brass, Blue	

Spec

Input voltage : DC24V

Power consumption : 26.4W

Weight : 456g

Number of LEDs : 66

Max. sets connectable : 9m

Environment : Indoors,Outdoors, Bath room, Wash room

(limited to places where water does not accumulate and which rainstorms do not hit directly)

Accessories : Mounting screw (6pcs)

Option parts : Power supply cable, Joint cable,

End clip

Light Source color : White : 40 : 4000K (2510lm / Ra83)

Warm white 3500K : 35 : 3500K (2510lm / Ra83)

Warm white 3000K : 30 : 3000K (2490lm / Ra83)

Warm white 2700K : 27 : 2700K (2420lm / Ra83)

Item Number

L-ELA9K2-132E40L-24C-P
L-ELA9K2-132E35L-24C-P
L-ELA9K2-132E30L-24C-P
L-ELA9K2-132E27L-24C-P
L-ELA9K2-132E40N-24C-P
L-ELA9K2-132E35N-24C-P
L-ELA9K2-132E30N-24C-P
L-ELA9K2-132E27N-24C-P

Job/Project Name

Area/Location/Circuit No.

Product Code

Qty.

Length(mm)

Luci Pte. Ltd. <http://www.luci.co.jp>

E-mail: info@luci.co.jp

LUCI (SHANGHAI) LIGHTING TECHNOLOGY CO., LTD.

Singapore World HQ
Tel: +65-6291-2410

Hong Kong Marketing Office
Tel: +852-2219-8462 / Fax: +852-2219-8461

Korea Office
Tel: +82-2-508-2541

Shanghai China mainland Regional HQ
Tel: +86-21-5238-9115 / Fax: +86-21-5238-8727

E-mail: info@luci.co.jp